

# AIR+ SMART MASK

## Instructions for use

1. The instructions for use and warning are guides to the proper use of the mask and to prevent health risk. They must be carefully read, completely understood and properly followed.
2. No alteration or modification is allowed to the mask. The mask should not be worn when it is contaminated (eg. dusty, wet, etc) or damaged (eg. broken part, hole, etc.) The contaminated or damaged mask must not be used.
3. The mask must not be used continuously for more than 8 hours (a single work shift). Always replace a new mask, whenever the breathing resistance becomes excessive or after using continuously for 8 hours.
4. The wearer of the respirator must be well trained to use it properly before starting work.
5. Before use of these respirators, a written respiratory protection program must be implemented, meeting all the requirements of OSHA 29 CFR 1910.134, including training, medical evaluation and fit testing.

## Storage

The respirator must be stored in its original packaging and stored in a clean cool and dry atmosphere to ensure that it is protected against dust, chemicals, moisture, excessive heat and direct sunlight.



-5°C~+50°C



<85%



## Instructions for fitting

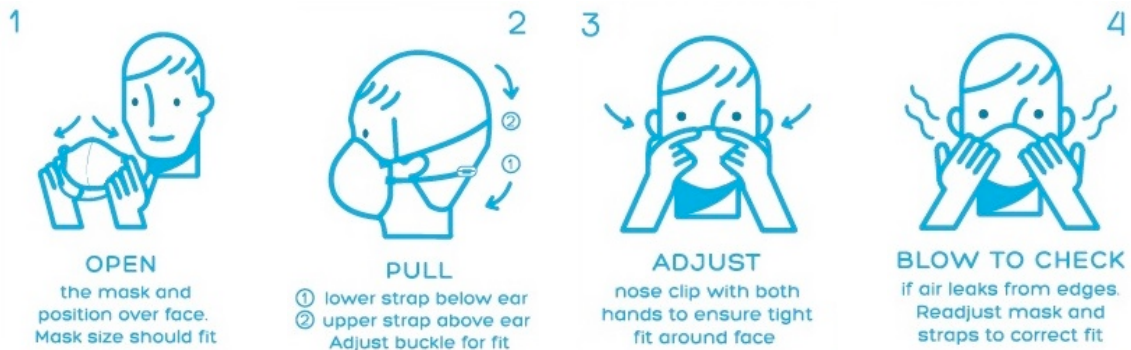

1. Before using, check the mask for hole, tear or other damage to its surface, strap and/or nose cushioning to ensure that your mask works well. Replace with a new mask, if damaged.



2. Select the right mask's size to fit your face. Consult the given size chart on the box for size selection, if your selected size fails to fit your face properly, choose another size until the proper size to fit your face is obtained. Please refer to the fitting instructions diagrams and procedures 3 to 5 below.

3. Fold the nose clip like  shape for a proper fit.

4. The mask strap can be adjusted for proper fit. Pull the strap outwards at either side of the buckle for tighter fit; push the strap inwards at either side of the buckle for looser fit.

5. To ensure a tight seal on your face, cover the middle surface of the mask with one hand and exhale deeply. Do not push the mask against your face. If you feel air blowing at your face or eyes, the mask's position and strap needs to be re-adjusted. Repeat the above steps until you do not feel air blowing at your face or eyes.



Champak Enterprise co., Ltd  
No 27-1, Jhaiming St. Dasi Town  
Taoyuan County 335 Taiwan  
886 3 380 8818



THIS RESPIRATOR IS APPROVED ONLY IN THE FOLLOWING CONFIGURATION:

TC-	Protection <sup>1</sup>	Respirator			Cautions and Limitations <sup>2</sup>
		AP520S	AP520M	AP520L	
84A-7228	N95	X	X	X	ABCJMNOP

1. Protection

N95- Particulate Filter (95% filter efficiency level) Effective against particulate aerosols free of oil; time use restrictions may apply
--

2. Cautions and Limitations

- A - Not for use in atmospheres containing less than 19.5% oxygen.
- B - Not for use in atmospheres immediately dangerous to life or health.
- C - Do not exceed maximum use concentrations established by regulatory standards.
- J - Failure to properly use and maintain this product could result in injury or death.
- M - All approved respirators shall be selected, fitted, used, and maintained in accordance with MSHA, OSHA, and other applicable regulations.
- N - Never substitute, modify, add, or omit parts. Use only exact replacement parts in the configuration as specified by the manufacturer.
- O - Refer to User's Instructions, and/or maintenance manuals for information on use and maintenance of these respirators.
- P - NIOSH does not evaluate respirators for use as surgical masks.

## **Warning**

1. Do not use the mask as protection against toxic particle, gas, vapor or solvent from spray-painting operation.
2. Do not use the mask in enclosed space, tank, inadequately ventilated area, oxygen-deficient environment (<19.5% in volume), hazardous environment, or in any circumstance where toxic gas is likely to be present.
3. Do not use the mask when the concentration of contaminant is dangerous for life or health. The concentration, toxicological characteristics and type of substances should be known.
4. Leave the work area immediately if breathing becomes difficult, dizziness or any other sign of distress occurs.
5. It is important to ensure proper fit on your face before using the mask.
6. The mask should not be worn under condition preventing a proper fit on your face. Such conditions may include growth of beard, mustache, sideburn, the use of spectacles or any other device containing strap which passes between the mask's sealing edge and the user's face.
7. If allergy occurs when mask is in contact with your skin, the mask should be removed immediately.

Champak Enterprise co., Ltd  
No 27-1, Jhaiming St. Dasi Town  
Taoyuan County 335 Taiwan

Model number: AP520S, AP520M, AP520L

LOT:

Made in Taiwan